

### NEOREST AH Luxurious Integrated Toilet

# CS985VA / TCF9786WA (DISCONTINUED)

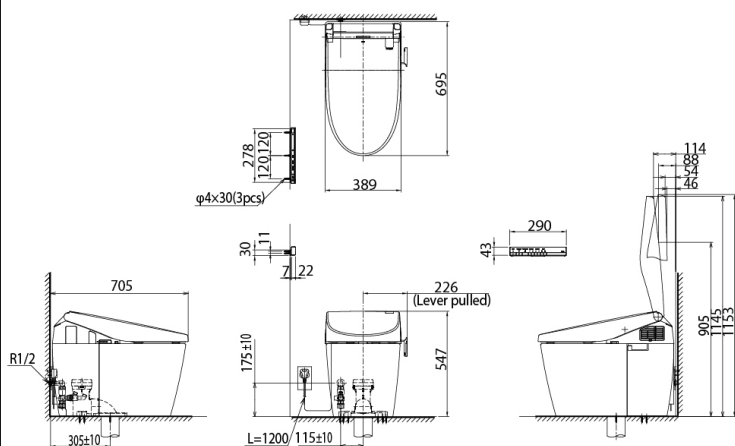

CS985VA /  
TCF9786WA



( )Recommended Dimension

## Features

- Hybrid Ecology System  
- WATER SAVING dual flush 3.8 / 3L  
- minimum required water pressure only at 0.05MPa (Dynamic)
- TORNADO FLUSH for powerful flushing effect with less amount of water
- EWATER+ keeps toilet bowl and nozzle clean by prebenting bacteria with sanitizing effect
- CEFIONTECT prevent debris on toilet surface
- Fully equipped with comfortable rear, front and oscillating cleansing functions
- Auto lid opening and closing function
- Auto Soft light function usable for night time usage

EWATER+, highly effective sanitizer created by electrolyzed chloride ion in tap water. After use, it returns back to original state, environmental friendly

## Specifications

Flush system:	TORNADO FLUSH
Water Use:	3.8L / 3L
Rough-in:	305 mm
Bowl Shape:	Elongated
Water Pressure:	0.05MPa~0.75MPa
Power Rating:	220~240V, 50/60Hz, 830~839W
Length of Power Cord:	1.2 m
Material:	Bowl - Vitreous China Seat & Cover -Plastic Remote Controller -Aluminium

## Parts description

- **CS985VA**  
Elongated Closet Bowl (S-Trap)  
(Rough-in 305)
- **TCF9786WA**  
WASHLET unit

## Colors

White (CEFIONTECT)