

## WALL HUNG TOILET



## Features

- WATER SAVING
- Easy cleaning wall hung design

## Specifications

Flush system:	Siphon-Jet
Water Use:	4.5L
Rough-in:	H=155 mm
Bowl Shape:	Elongated
Water Pressure:	0.07MPa~0.75MPa
Size:	385Wx622Dx424H mm

## Parts description

Seat & Cover are not included

- **CW708EH**  
Elongated Wall Hung Closet Bowl (Back Inlet) (P-Trap) (Rough-in 155)
- **TEF75LNV100**  
Concealed Automatic Toilet Flush Valve w/ Box
- **TEF75LNV110**  
Concealed Automatic Toilet Flush Valve w/ Box
- **HTH633-4**  
P-Seal
- **TX801C**  
Support Fitting
- **TX253C**  
Wall Mounting Bolt
- **TX802C**  
Inlet Spud

### Optional Parts

- TC393VS  
Soft Close Seat & Cover (Urea Resin)
- TC281SJ  
Soft Close Seat & Cover (Urea Resin)

## Colors

White, White (CEFIONTECT)

CW708EH

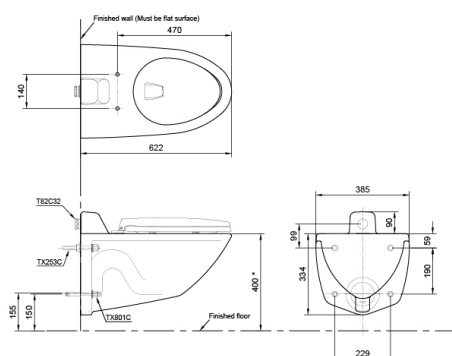

( )Recommended Dimension