

WALL HUNG TOILET



Features

- WATER SAVING
- Easy cleaning wall hung design

Specifications

Flush system:	Siphon-Jet
Water Use:	4.5L
Rough-in:	H=155 mm
Bowl Shape:	Elongated
Water Pressure:	0.07MPa~0.75MPa
Size:	385Wx622Dx424H mm

Parts description

Seat & Cover is **not included**.

- **CW708EH**
Elongated Wall Hung Closet Bowl (Back Inlet) (P-Trap) (Rough-in 155)
- **TEF75LNV100**
Concealed Automatic Toilet Flush Valve w/ Box
- **TEF75LNV110**
Concealed Automatic Toilet Flush Valve w/ Box
- **HTH633-4**
P-Seal
- **TX801C**
Support Fitting
- **TX253C**
Wall Mounting Bolt
- **TX802C**
Inlet Spud

Optional Parts

- TC393VS
Soft Close Seat & Cover (Urea Resin)
- TC281SJ
Soft Close Seat & Cover (Urea Resin)

Colors

White, White (CEFIONTECT)

CW708EH

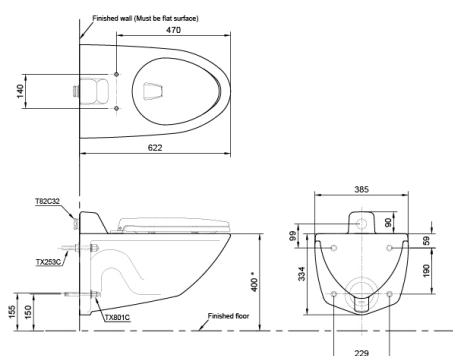

()Recommended Dimension